



TRI-MAG, Inc.

® *your* POWER Specialists

1601 N. CLANCY CT. • VISALIA, CA 93291
(559) 651-2222 • FAX (559) 651-0188
<http://www.tri-mag.com>
<http://eemonline.com/tri-mag>
tri-mag@worldnet.att.net

UV440M SERIES

40 Watt

UNIVERSAL INPUT

For Medical Application



GENERAL SPECIFICATIONS

Input Voltage.....	85VAC to 265VAC or 120VDC to 350VDC
Input Frequency.....	47Hz to 65Hz
Inrush Current (cold).....	15A @ 115VAC 30A @ 230VAC
Operating Temperature.....	0 to 50°C Linear Derating to 50% load @ 70°C
Storage Temperature.....	- 20°C to 85°C
Cooling.....	Free Air Convection
Efficiency.....	70% Typical
Holdup Time.....	20ms at 115VAC
Overvoltage Type.....	Crowbar Trip Point, 6.2V ± 0.4V or Rated Output +2V
Overload Protection.....	Foldback at 150% load
Output #1 Voltage Adjustable.....	±10%
Switching Frequency.....	>30KHz
Safety:	
Designed in full compliance with.....	UL 544 CSA 22.2 #601-1 VDE EN60601-1 IEC 601

DESCRIPTION

Tri-Mag, Inc. UV440M Series is a 40 watt switchers feature small size, low cost, high efficiency with universal input voltage (80-265VAC) without jumpers.

Both single output and multiple output models are available. The UV440M Series is designed in full compliance to UL544, CSA22.2#601-1, and VDEEN60601-1, IEC601. This series is designed for medical applications.

FEATURES

- 85 TO 265VAC Universal Input
- Innovated Mosfet Design
- Low Cost
- High Efficiency
- Built-in Line Filter to Meet FCC Class B
- 100% Hi-Pot Test
- 100% Cycling On-Off Burn-In Test
- Low Leakage Current

APPLICATIONS

- Small Digitally Based System Used in Medical and Dental Environment
- Any System Requiring Low Leakage Current Power Supply

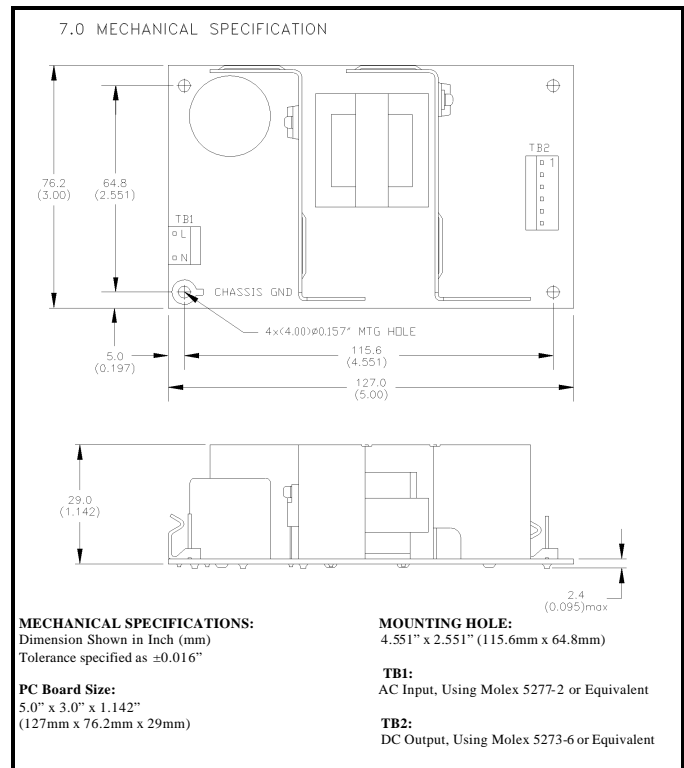
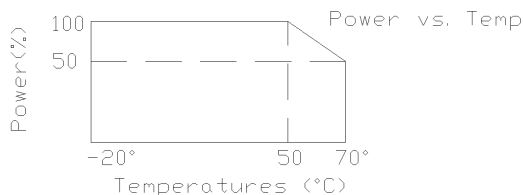

**TRI-MAG, Inc.**® *your* **POWER Specialists**

1601 N. CLANCY CT. • VISALIA, CA 93291

(559) 651-2222 • FAX (559) 651-0188

<http://www.tri-mag.com><http://eemonline.com/tri-mag>

tri-mag@worldnet.att.net

UV440M SERIES 40 WATT— PIN ASSIGNMENT

Pin	1	2	3	4	5	6
UV440M-1	+12V	+5V	+5V	COM	COM	-12V
UV440M-2	+15V	+5V	+5V	COM	COM	-15V
UV440M-4	+5V	+5V	+5V	COM	COM	COM
UV440M-5	+12V	+12V	+12V	COM	COM	COM
UV440M-6	+15V	+15V	+15V	COM	COM	COM
UV440M-7	+24V	+24V	+24V	COM	COM	COM
UV440M-19	+13.8V	+13.8V	+13.8V	COM	COM	COM

UV440M SERIES 40 WATT— OUTPUT SPECIFICATIONS

Model	Voltage (Vdc)	Load (A)			Tolerance ±	Ripple & Noise	Regulation	
		Min.	Rate	Peak			Line	Load
UV440M-1	+5V	0	3.0	6.0	1%	50 mV	1%	3%
	+12V	0	2.0	4.0	3%	100 mV	2%	3%
	-12V	0	0.3	0.5	3%	100 mV	3%	5%
UV440M-2	+5V	0	3.0	5.0	1%	50 mV	1%	3%
	+15V	0	1.6	3.0	3%	100 mV	2%	3%
	-15V	0	0.3	0.5	3%	100 mV	3%	3%
UV440M-4	+5V	0	8.0	10.0	1%	50 mV	1%	1%
UV440M-5	+12V	0	3.3	5.0	1%	100 mV	1%	1%
UV440M-6	+15V	0	2.6	4.0	1%	100 mV	1%	1%
UV440M-7	+24V	0	1.7	2.5	1%	240 mV	1%	1%
UV440M-19	+13.8V	0	3.0	-	1%	100 mV	1%	1%

Note: Contact factory for Safety Agency Approved status.

All specifications and prices subject to change without notice